

ROTATING RIGHT

# NATIONAL OILWELL 20T-25 TECHNICAL DATA SHEET



## Triplex Plunger Pump

# 20T-25

Rated input horsepower  
"T" Triplex  
Stroke length (in.)

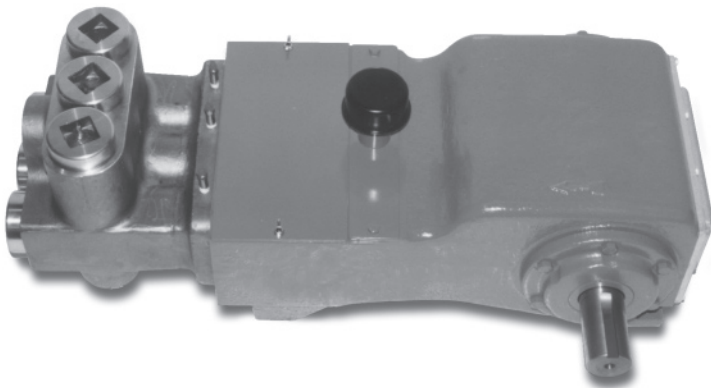

This 2 1/2" stroke pump is designed for a variety of fluid transfer applications.

### Field Connections in. (mm)

Pump Model	Discharge Connection Size	Suction Connection Size
20T-25	1-1/4 (31.8) FNP Threaded.	2 (50.8) FNP Threaded.

### Dimensions

Pump Type	Length	Width	Height
20T-25	31"	17"	10-3/4"

## Pump Specifications

Pump Size (Max. Plunger Diameter x Stroke) in. (mm) .....2 x 2-1/2 (50.8 x 63.5)  
 Rated BHP At 400 RPM (Kw) .....20 (15)  
 Rated Plunger Load, pounds (Kg).....2,560 (1162)

**Maximum Working Pressure:** PSI (kPa) .....2,350 (16,192)

**Crankshaft Extension:** in. (mm) .....2 (50.8)

**Weight:** - Lbs. (Kg)

Pump Only On Wood Shipping Skids.....340 (153)

## Standard Equipment

- Aluminum Bronze Fluid End
- Aluminum Bronze Valve Covers
- Aluminum Bronze Stuffing Boxes & Nuts
- Bronze Stuffing Box Internals
- Ceramic or Metal Plungers
- General Service Plunger Packing
- Stainless Steel Intermediate Rods
- Chamber Cover
- Crankcase Breather

## Optional Equipment

- Alternate Fluid End Materials
- Alternate Fluid End Valve Styles
- Custom Designs For Specialized Applications

## Accessories

- Packing Lubricator
- Pulsation Dampeners
- Relief Valves
- Valve Service Kit
- Complete Unitization Services

**Continuous Duty Performance Data** (Volumes Indicated Are Displacement of Incompressible Fluid)

**English Units**

Plunger Dia. In.	Plunger Area (Sq. In.)	BPD Per RPM	GPM Per RPM	Max. Press. PSI	100 RPM		150 RPM		200 RPM		250 RPM		300 RPM		350 RPM		400 RPM			
					BPD	GPM	BPD	GPM	BPD	GPM	BPD	GPM	BPD	GPM	BPD	GPM	BPD	GPM		
<b>20T-25</b>																				
1	0.7854	0.8747	0.0255	2350	87	2.55	131	3.83	175	5.10	219	6.38	262	7.65	306	8.93	350	10.20		
1 1/4	1.2272	1.3666	0.0398	2086	137	3.98	205	5.98	273	7.97	342	9.96	410	11.95	478	13.95	547	15.94		
1 1/2	1.7672	1.9680	0.0574	1449	197	5.74	295	8.61	394	11.48	492	14.34	590	17.21	689	20.08	787	22.95		
1 3/4	2.4053	2.6786	0.0781	1064	268	7.81	402	11.71	536	15.62	670	19.52	804	23.43	938	27.33	1071	31.24		
2	3.1416	3.4986	0.1020	815	350	10.20	525	15.30	700	20.40	875	25.50	1050	30.60	1225	35.70	1399	40.80		
Brake Horsepower Required:					5.4		8.0		10.8		13.5		16.1		18.9		20			

**Metric Units**

Plunger Dia. mm	Plunger Area Sq. cm.	M <sup>3</sup> /D Per RPM	L/Min. Per RPM	Max. Press. kPa	100 RPM		150 RPM		200 RPM		250 RPM		300 RPM		350 RPM		400 RPM			
					M <sup>3</sup> /D	L/Min.	M <sup>3</sup> /D	L/Min.	M <sup>3</sup> /D	L/Min.	M <sup>3</sup> /D	L/Min.	M <sup>3</sup> /D	GPM	M <sup>3</sup> /D	L/Min.	M <sup>3</sup> /D	L/Min.		
<b>20T-25</b>																				
25	5.0671	0.1391	0.0965	16,203	14	9.65	21	14.48	28	19.30	35	24.13	42	28.96	49	33.78	56	38.61		
32	7.9174	0.2173	0.1508	14,382	22	15.08	33	22.62	43	30.16	54	37.70	65	45.24	76	52.78	87	60.32		
38	11.4010	0.3129	0.2172	9,991	31	21.72	47	32.57	63	43.43	78	54.29	94	65.15	110	76.01	125	86.87		
44	15.5180	0.4259	0.2956	7,336	43	29.56	64	44.34	85	59.12	106	73.90	128	88.68	149	103.45	170	118.23		
51	20.2684	0.5562	0.3861	5,619	56	38.61	83	57.91	111	77.21	139	96.52	167	115.82	195	135.12	222	154.43		
Kilowatts Required:					4		6		8		10		12		14		15			

Volume is based on 100% volumetric efficiency. Brake horsepower is based on 90% mechanical efficiency.

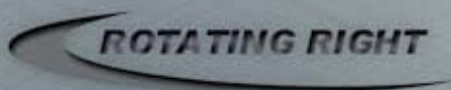

**Head Office:**  
6120 Davies Road  
Edmonton, AB  
T6E 4M9

Phone: (780) 485-2010 • Toll Free: (866) 707-7867  
Fax: (780) 485-1938  
• Calgary • Drayton Valley • Lethbridge  
[www.rotatingright.com](http://www.rotatingright.com)