

ROTATING RIGHT

GM 5.7L VORTEC ENGINE

GM

POWERTRAIN Industrial Engines



GM Powertrain takes its expertise in designing outstanding Vortec truck and SUV engines and leverages it to make sophisticated yet extremely durable industrial engines.

Applications

Industrial, Agriculture
Construction & Oilfield

- Pumps –Irrigation, Industrial, Hydraulic Sludge and Trash
- Compressors – Natural Gas and Air
- Generators –Prime Power, Standbyand Co-Gen
- Industrial Drives – Forklifts, Manlifts, Street Sweepers, Wood Chippers, Chillers and Fans
- Oil and Gas Production - Gas Compressors, Pump Jacks, Vapor Recovery
- Wind Machines
- Numerous Re-Power & Custom Applications

Available Factory Installed Options

- Natural Gas and LPG Fuel Systems
- Ignition Systems
- Belt and Pulley Accessory Drives
- Starters and Alternators
- Spark Protected Ignition
- Exhaust Headers & Manifolds
- Mufflers
- SAE 3 Flywheel Housing and Direct Drives
- PTOs: Side Load and In-Line
- Instrument Panel w/Gauges and Safety Shutdowns
- Governor Electronic & Mechanical
- Radiator and Heat Exchanger Cooling Systems
- Engine Mounting Frames and Enclosures
- Three Way Catalyst

Vortec™ 5.7L 8 Cylinder – 350 Cubic Inches



Features & Benefits:

- Designed for gasoline, propane and natural gas fuel.
- Intake manifold is standard on the engine
- Hydraulic roller lifter camshaft is optimized for maximum performance
- Composite front cover for noise reduction
- Nodular iron crankshaft for increased strength and durability.
- High Energy Ignition (HEI) distributor and coil are standard.
- Induction-hardened inlet valve seats and sintered powder metal exhaust valve seat inserts for maximum durability Intake manifold standard
- World-class engine sealing system uses composite cylinder head gaskets with steel cores, a one-piece rear main crankshaft seal, a one-piece oil pan seal and molded rocker cover seals
- Positive inlet valve stem seals to control oil consumption
- Common GM Powertrain industrial engine rear face for easy housing installation



POWERTRAIN Industrial Engines



Vortec™ 5.7L 8 Cylinder – 350 Cubic Inches

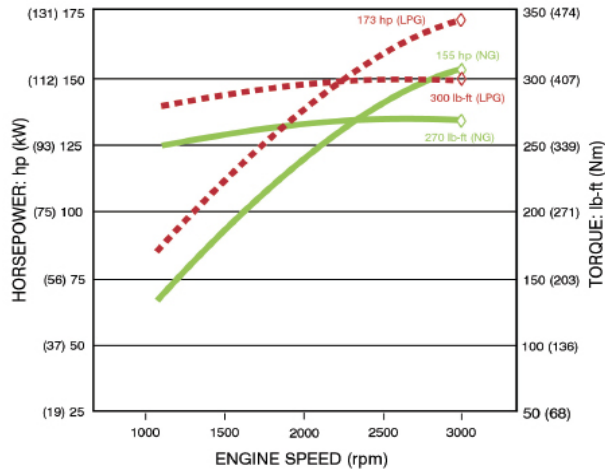

Power and torque figures provided by GM Powertrain per SAE J1995. Actual power levels may vary depending on fuel selection and quality, calibration, application, altitude and ambient air temperatures.

CONTINUOUS BRAKE HORSEPOWER

FOR HIGH PLAINS IRRIGATION APPLICATION

GEARHEAD	1x1	6x5	5x4	4x3	3x2
ENGINE RPM	1760	2112	2200	2346	2640
BHP	70	82	86	95	110

RATED @ 3200 FT ELEVATION WITH NATURAL GAS FUEL

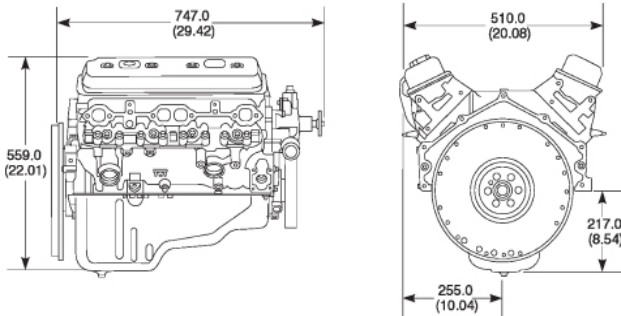

Horsepower:

173 hp @ 3000 rpm (Propane)
 155 hp @ 3000 rpm (Natural Gas)

Torque:

300 lb-ft @ 3000 rpm (Propane)
 270 lb-ft @ 3000 rpm (Natural Gas)

Specifications and Materials

- Type: 90°5.7L V8
- Displacement: 350 cld (5736 cc)
- Compression Ratio: 9.4:1
- Valve Configuration: Overhead /Pushrod Actuated
- Valve Lifters: Hydraulic Roller
- Bore x Stroke: 4.00 x 3.48 in (101.60 x 88.39 mm)
- Main Bearing Caps: 2-Bolt
- Balance Method: External
- Intake Manifold: Two barrel
- Firing Order: 1-8-4-3-5-7-2
- Oil Pan Capacity: 5 qt without oil filter
- Fuel Type: Gasoline, Propane or Natural Gas
- Engine Rotation: Clockwise (from the front)
- Paint Protection: Component Painted
- Shipping Weight: 434 lb (197 kg)
- Block: Cast Iron
- Cylinder Head: Cast Iron
- Intake Manifold: Cast Aluminum
- Final Assembly: Lubbock, TX USA

Manufactured with US, North American and Global Sourced Content

Information may vary by model and application. All specifications, options and product availability based upon the latest information available at time of publication. To ensure our customers have access to the highest quality products available we reserve the right to make product improvements and changes anytime without prior notice. Vortec™ trademarks are property of General Motors Corporation. ©2005 1/05



Head Office:
 6120 Davies Road
 Edmonton, AB
 T6E 4M9

Phone: (780) 485-2010 • Toll Free: (866) 707-7867
 Fax: (780) 485-1938
 • Calgary • Drayton Valley • Lethbridge
www.rotatingright.com